

## Dati Tecnici - Specifications

	cond	comp. W	ABS. W	Fuse	Kwh/100Kg	l / h	kg	Lbs	kg	Lbs	Ton CO2 equiv.
M202 A		2348	1100	16	13.8	10	70	154	85	187	1.50
M202 W		2348	1000	16	11.6	105	70	154	85	187	1,07

## 24h Produzione Ghiaccio - Ice Production

### Raffreddamento ad aria - Air Cooled Unit

Temp. aria Air Temp.	Temp. acqua / Water Temp.			
	32°	21°	15°	10°
°C	32°	21°	15°	10°
°F	90°	70°	60°	50°
10°	<b>185</b>	<b>215</b>	<b>230</b>	<b>240</b>
50°	408	474	507	529
21°	<b>175</b>	<b>200</b>	<b>215</b>	<b>220</b>
70°	386	441	474	485
32°	<b>135</b>	<b>155</b>	<b>160</b>	<b>165</b>
90°	298	342	353	365
38°	<b>120</b>	<b>133</b>	<b>138</b>	<b>140</b>
100°	265	293	302	309

### Raffreddamento ad acqua - Water Cooled Unit

Temp. aria Air Temp.	Temp. acqua / Water Temp.			
	32°	21°	15°	10°
°C	32°	21°	15°	10°
°F	90°	70°	60°	50°
10°	<b>170</b>	<b>195</b>	<b>210</b>	<b>215</b>
50°	375	430	463	474
21°	<b>158</b>	<b>183</b>	<b>197</b>	<b>202</b>
70°	348	403	434	445
32°	<b>150</b>	<b>175</b>	<b>182</b>	<b>187</b>
90°	331	386	401	412
38°	<b>145</b>	<b>170</b>	<b>175</b>	<b>180</b>
100°	320	375	386	397

Vista frontale  
Front view

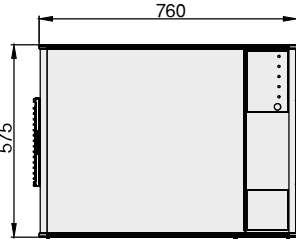

Vista laterale  
Lateral view

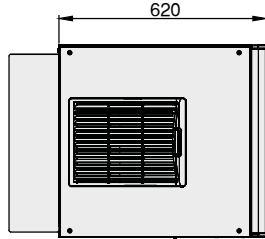

Vista superiore  
Top view

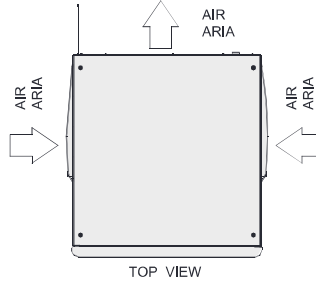

AIR COOLED

WATER COOLED

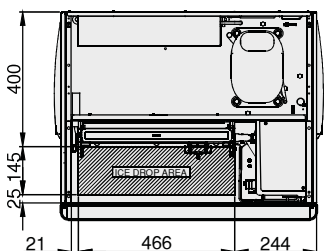
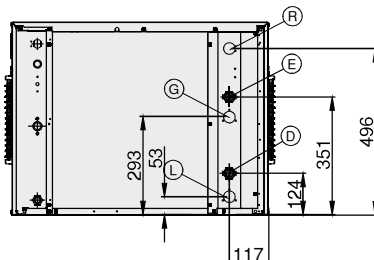
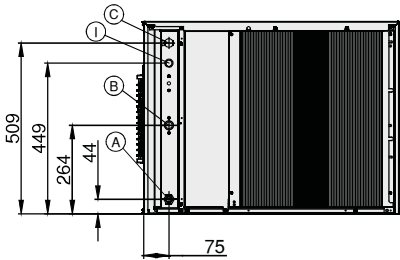

- (A) Water drain Ø20 mm
- (B) Potable water inlet 3/4 GAS
- (C) Electrical cable supply
- (D) Water cooled inlet 3/4 GAS
- (E) Water cooled outlet 3/4 GAS
- (G) Remote cond. disch. line 1/2" male quick connection
- (I) ON-OFF Switch (option)
- (L) Remote cond. liquid line 3/8" male quick connection
- (P) High pressure reset (optional)
- (R) Remote connection for condenser fans



### PANNELLO DI CONTROLLO - CONTROL PANEL

	Alimentazione Powered
	In Funzionamento Operating
	Deposito Pieno/Lavaggio Storage Full / Washing
	Allarme Alarm
	Allarme Alta Pressione High Pressure Alarm
	Pulsante Reset/Lavaggio Button Reset/Washing

### DIMENSIONI - DIMENSIONS

LxPxH(mm): 760 x 620 x 575  
WxDxH(in):2915/16"x247/16"x2210/16"

### DEPOSITO - SLOPE BIN

D205 - D255 - D305 (KM305)  
D405 (KFM404)-D505 (KFM505)

### TIPO GHIACCIO - ICE TYPE

	<b>HALF-LARGE</b> 10 x 29 x 24 - 6 gr <b>370</b> PZ. / CICLO PCS / CYCLE
	<b>DICE</b> 22 x 22 x 24 - 10 gr <b>234</b> PZ. / CICLO PCS / CYCLE
	<b>LARGE</b> 29 x 29 x 24 - 17 gr <b>140</b> PZ. / CICLO PCS / CYCLE

### CONDIZIONI USO-OPERATING REQUIREMENTS

	220-240V / 1 / 50HZ		R452A GWP=2141
	MIN		MAX
	10°C (50°F)		40°C (104°F)
	5°C (41°F)		35°C (95°F)
	- 10 %		+ 10 %
	1 BAR (14 PSI)		5 BAR (70 PSI)
Calore espulso - Rejected Heat		<b>2432 W</b>	
Volume aria - Air Volume		<b>590 m³/h</b>	