

**PROJECT**  
AIRPORT,  
DELHI

**CLIENT**  
TACO BELL

**NOTE:**  
THIS DRAWING & DESIGN IS THE COPYRIGHT OF THE DESIGNER. NO PORTION MAY BE REPRODUCED WITHOUT THE WRITTEN PERMISSION OF THE DESIGNERS

1. ALL DIMENSIONS ARE INCLUDING FINISHES
2. DO NOT SCALE DRAWING. ONLY MENTIONED DIMENSIONS ARE TO BE CONSIDERED.
3. ALL DIMENSIONS MUST BE CHECKED BEFORE COMMENCING WORK ON SITE.
4. ANY DISCREPANCIES SHALL BE BROUGHT UNDER THE NOTICE OF ARCHITECTS PRIOR COMMENCEMENT OF WORK.

**REVISION**

S.NO.	REMARKS	DATE
1	REV 1	-
2	REV 2	-
3	REV 3	-
4	REV 4	-
5	REV 5	-
6	REV 6	-
7	REV 7	-
8	REV 8	-

**ARCHITECT / INTERIOR DESIGN**

**ARCHITECT**  
STUDIO

ARCHITECTURE PLANNING  
INTERIOR FURNITURE

B-6/26-1, SAFDARJUNG ENCLAVE,  
NEW DELHI - 110029.  
Ph. - 011-41079004

**CONSULTANT**

**CONSULTANT**

**RELEASE FOR**

INFORMATION	TENDER	CONSTRUCTION	AS BUILT

**TITLE**  
COUNTER DETAIL

DATE	27-10-2023
SCALE	NTS
DRAWN BY	ANKITA
CHECKED BY	AR.ANKIT
PRINTED BY	-
DWG. NO.	WD-D-13 C

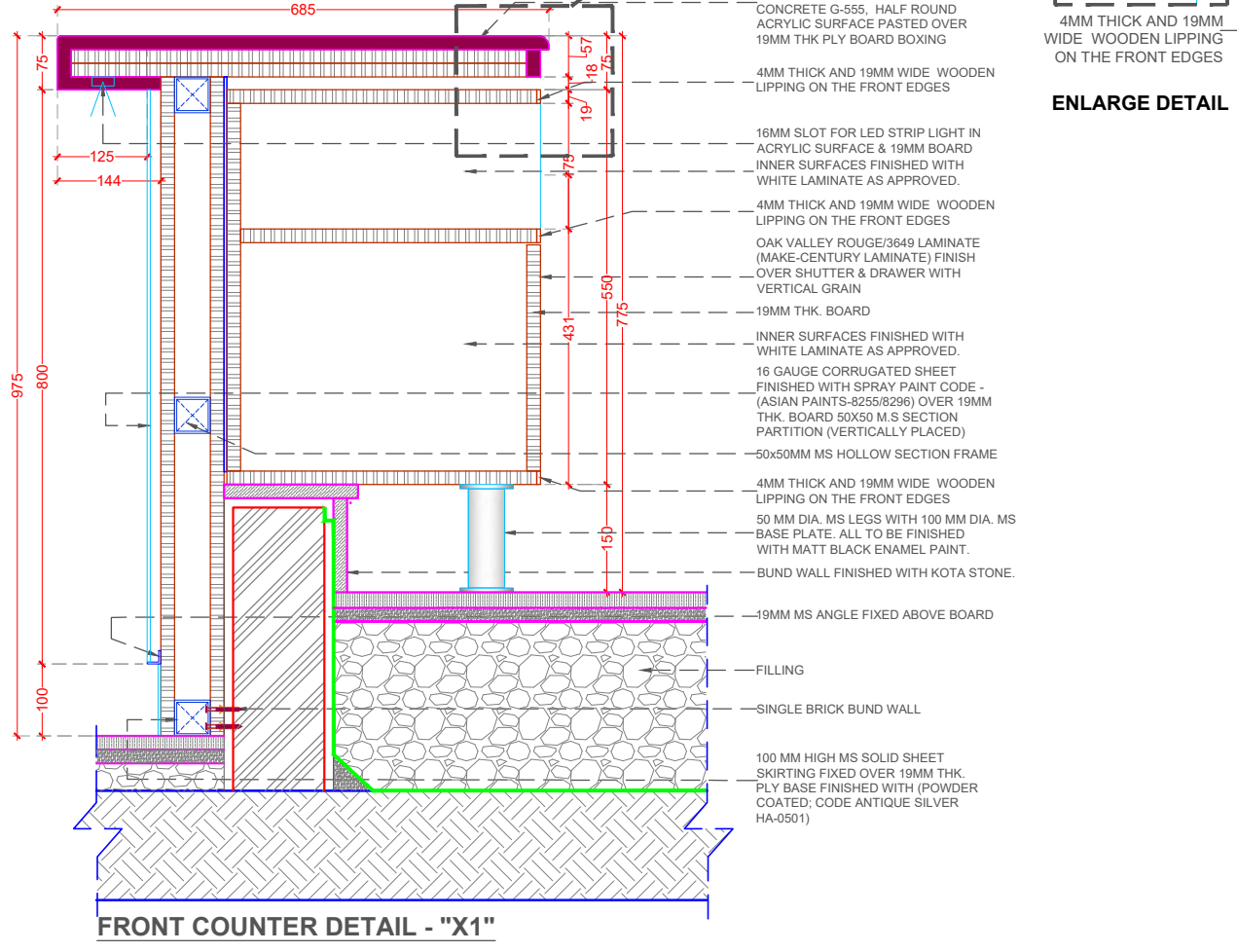
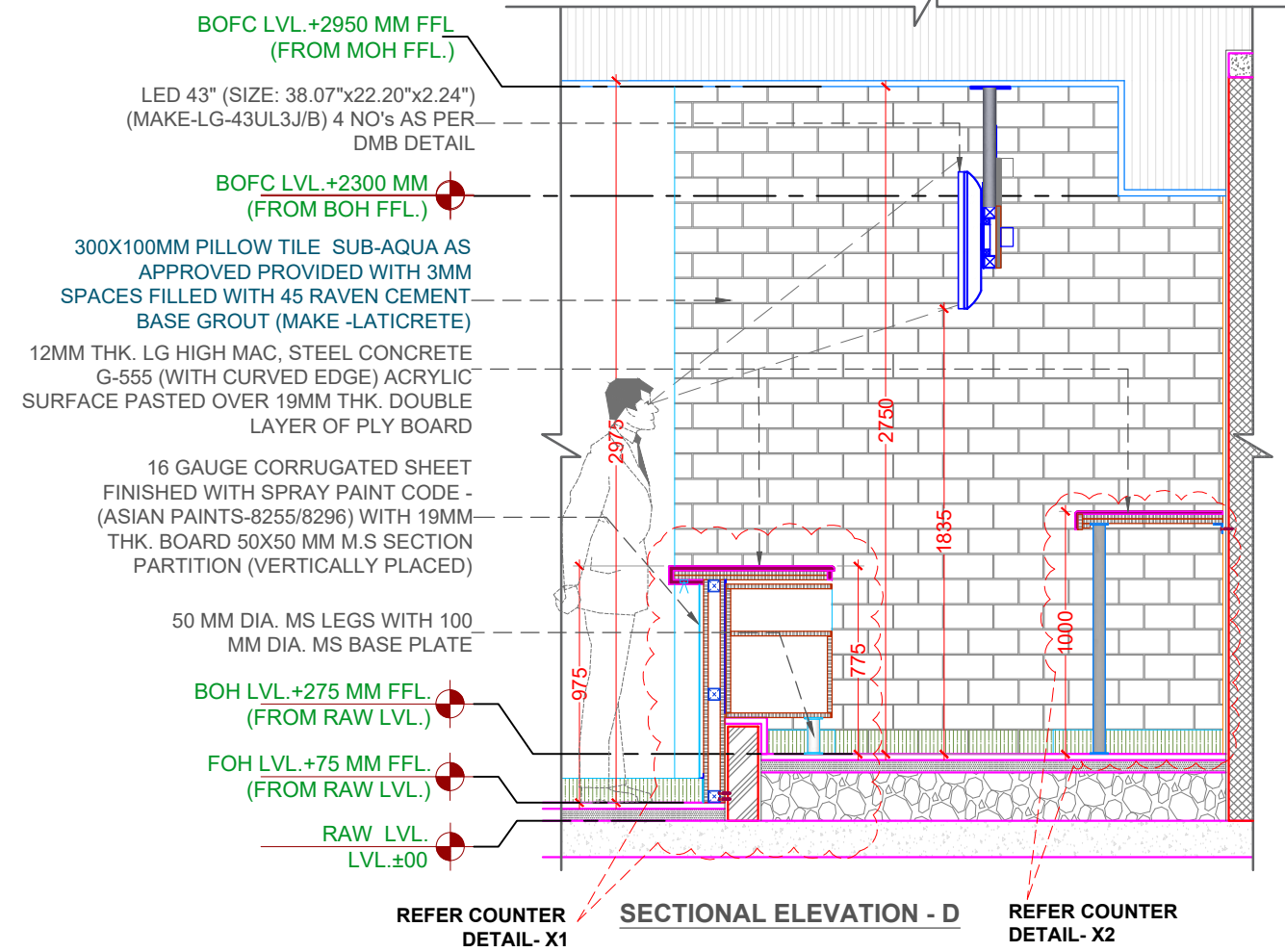

- CHECK POINT**
- a) DMB HEIGHT FROM FINISH FLOOR LEVEL - 6'2"
  - b) MINIMUM HEIGHT OF FRONT GRANITE COUNTER FROM BOH FINISH FLOOR LEVEL @ 2'-6"
  - c) TOP VIEWED WIDTH OF FRONT COUNTER ( ACRYLIC SURFACE FINISHED COUNTER IS 1'-6" + JET BLACK GRANITE FINISHED COUNTER IS 1'-3") = 2'-9"

