

PROJECT
AIRPORT,
DELHI

CLIENT
TACO BELL

NOTE:
THIS DRAWING & DESIGN IS THE COPYRIGHT OF THE DESIGNER. NO PORTION MAY BE REPRODUCED WITHOUT THE WRITTEN PERMISSION OF THE DESIGNERS

1. ALL DIMENSIONS ARE INCLUDING FINISHES
2. DO NOT SCALE DRAWING. ONLY MENTIONED DIMENSIONS ARE TO BE CONSIDERED.
3. ALL DIMENSIONS MUST BE CHECKED BEFORE COMMENCING WORK ON SITE.
4. ANY DISCREPANCIES SHALL BE BROUGHT UNDER THE NOTICE OF ARCHITECTS PRIOR COMMENCEMENT OF WORK.

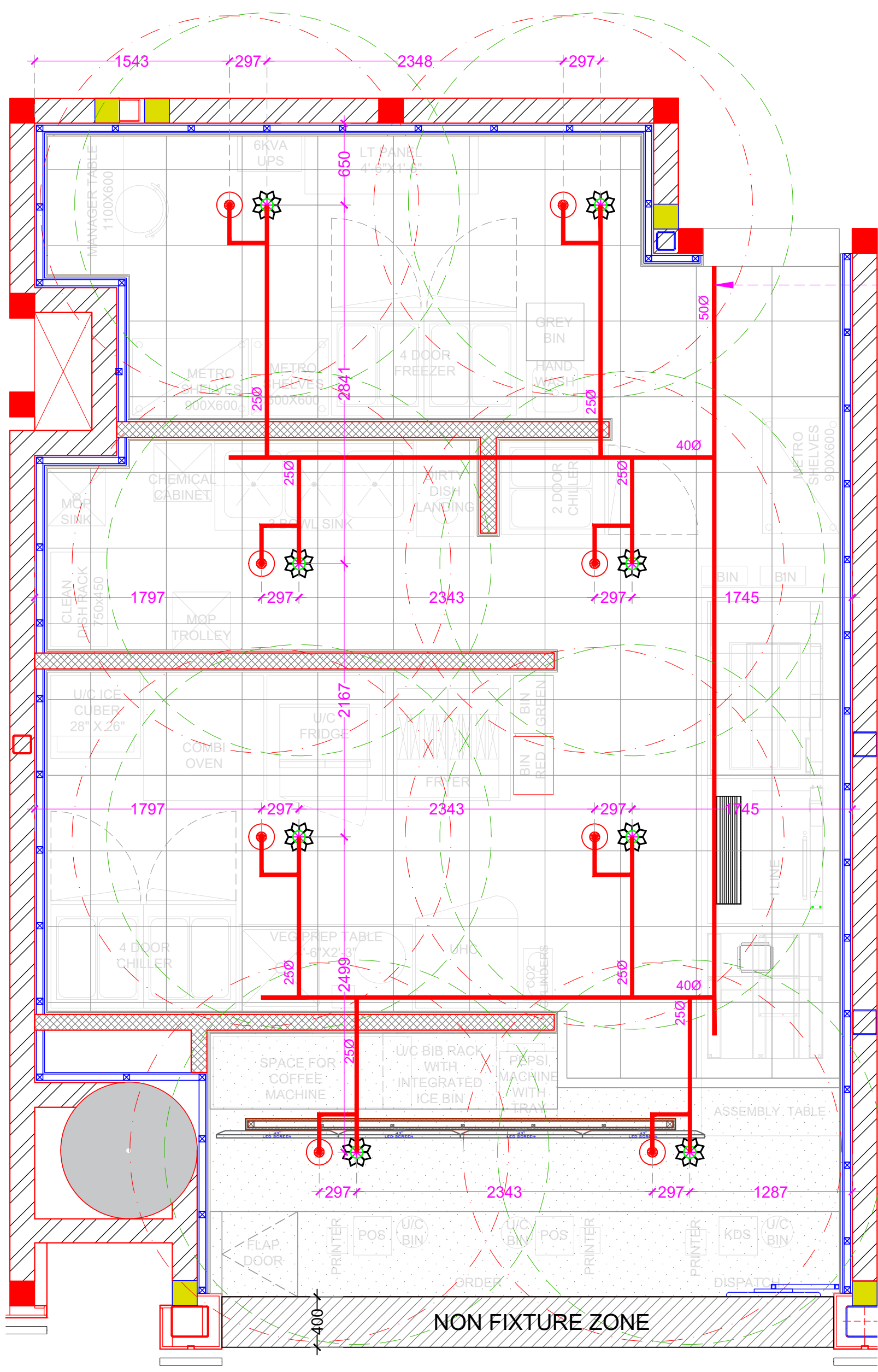

SPRINKLER
PIPE TAP
OFF POINT

SPRINKLER LEGEND

S.NO.	DESCRIPTION	SYMBOL	NOS
1.	PROPOSED BELOW FALSE CEILING PENDENT SPRINKLER-ACTIVATION TEMP 68° COVERED DIA 10FT		08
2.	ABOVE FALSE CEILING UPRIGHT SPRINKLERS		08
3.	SPRINKLER COVERING DIAMETER 10FT		
4.	UPRIGHT SPRINKLER COVERING DIAMETER 10FT)		
5.	FLOW SWITCH		
6.	BUTTERFLY VALVE		
7.	TEMPER SWITCH		
8.	PRESSURE GAUGE		

SPRINKLERS: GI-C CLASS HEAVY PIPES.
NOTE:
1. All sprinkler pipes to run 4" below the slab or beam above.
2. All below ceiling sprinklers to be fixed with flexible drops.
3. Sprinkler system needs to be executed as per IS1510.

REVISION

S.NO.	REMARKS	DATE
1	REV 1	00/00/00
2	REV 2	00/00/00
3	REV 3	00/00/00
4	REV 4	00/00/00
5	REV 5	00/00/00
6	REV 6	00/00/00
7	REV 7	00/00/00
8	REV 8	00/00/00

ARCHITECT / INTERIOR DESIGN

CONSULTANT

CONSULTANT

RELEASE FOR

INFORMATION	TENDER	CONSTRUCTION	AS BUILT
-------------	--------	--------------	----------

TITLE

SPRINKLER LAYOUT

DATE	19-10-2023
SCALE	NTS
DRAWN BY	ANKITA
CHECKED BY	AR. ANKIT
PRINTED BY	-
DWG. NO.	WD-D-10