



REFERENCE IMAGE FOR
DOME SHAPED
HANGING LIGHT

LIGHTING LEGEND -

SYMBOL	DISCRIPTION	COLOUR CODE	TEMP.	QTY
	15W 10" (250 MM DIA.) DOME SHAPED HANGING LIGHT (ABOVE LINEAR & COMMUNITY SEATING)	WARM WHITE	3000K	05
	12W CONCEALED WALL WASHER LIGHTS IN WHITE FIXTURE (FOR ARTWORK)	WARM WHITE	3000K	06
	AN - 2007 15 W LED CIRCULAR CONCEALED FITTING IN WHITE FIXTURE (FOH AREA)	WARM WHITE	3000K	44
	12W INDIRECT LED STRIP LIGHT (ABOVE LEDGE SEATING & IN FACADE)	WARM WHITE	2700K	APPROX 400 FT
	2*2 LED 36W CONCEALED RECESSED MIRROR OPTIC LIGHT (BOH AREA)	COOL WHITE	4000K	09
	24W LED SQUARE DOUBLE CONCEALED DOWN LIGHT- BLACK FIXTURE (MOH AREA)	COOL WHITE	4000K	11
	AN-2007 15 W, LED CIRCULAR CONCEALED FITTING IN WHITE FIXTURE (BOH AREA)TRAP DOOR	COOL WHITE	4000K	04
	15W LED SQUARE DOWN LIGHT CONCEALED 3000K (WARM WHITE LIGHT) IN WHITE FIXTURE WITH CLIP (FOR RAMP AREA)	WARM WHITE	3000K	01

CEILING LEGEND -

	GYPSUM CEILING TO BE FINISHED WITH PAINT (COTTON WOOL L -104 MAKE - ASIAN PAINTS) (@ FOH AREA & MOH AREA) (3000MM HT BOTTOM FROM AIRPORT FFL)
	2" X 3" HT. WOODEN RAFTER CEILING HANGED FROM MS STRUCTURE @ 3000MM HT BOTTOM FROM AIRPORT FFL (@ LINEAR BOOTH SEATING AREA)
	PERFORATED CEILING (@ FOH AREA) (3000MM HT BOTTOM FROM AIRPORT FFL)
	NEOLITH PANELS COLOUR-NERO CEILING (ABOVE RAMP) (3000MM HT BOTTOM FROM AIRPORT FFL)
	GYPSUM CEILING TO BE FINISHED WITH PAINT (COTTON WOOL L -104 MAKE - ASIAN PAINTS) (@ MOH AREA) (2656MM HT BOTTOM FROM AIRPORT FFL)
	METAL GRID CEILING (@ BOH AREA) (2656MM HT BOTTOM FROM AIRPORT FFL)

NO CEILING AREA IN BOH TO BE FINISHED
WITH LUSTER PAINT - DARK SHADOW-8294
(MAKE-ASIAN PAINTS)

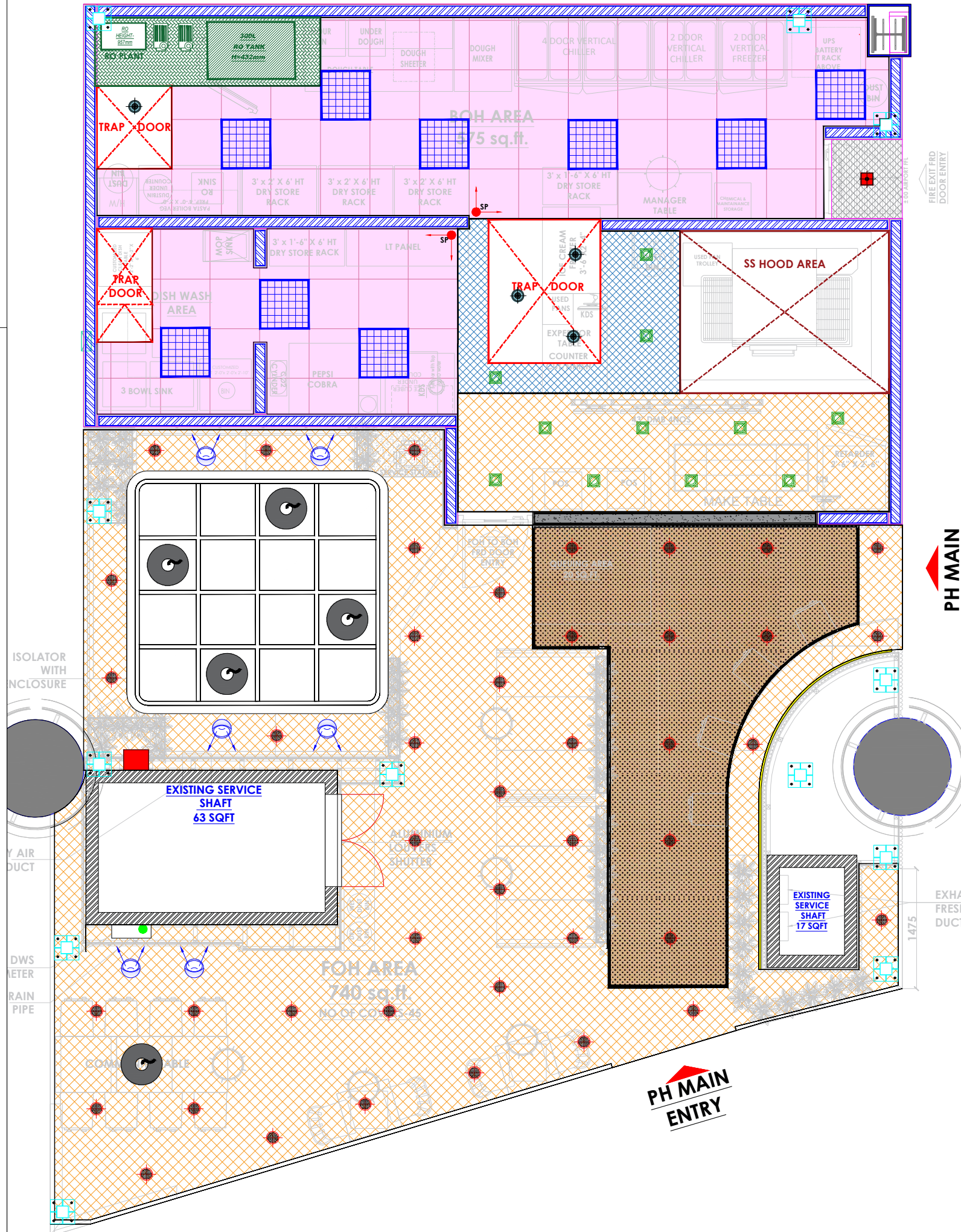

NOTES :

THE COPYRIGHT OF THIS DRAWING REMAINS WITH WHITE WATER DESIGN STUDIO AND IT MAY NOT BE REPRODUCED IN ANY WHICH MANNER WITHOUT PRIOR WRITTEN CONSENT.

- FIGURED DIMENSIONS ARE TO BE USED IN PREFERENCE TO SCALED SIZES. ALL DIMENSIONS MUST BE CHECKED BEFORE COMMENCING WORK ON SITE.
- THIS DRAWINGS TO BE READ IN CONJUNCTION WITH ALL OTHER RELEVANT DRAWINGS.
- ALL PROPOSED WORKS TO BE CARRIED OUT IN ACCORDANCE WITH TECHNICAL SPECIFICATIONS AND SCHEDULES MENTIONED FOR INTERIOR WORKS.
- READ THIS DRAWING IN CONJUNCTION WITH ALL CONSULTANTS' & SPECIALISTS' DRAWINGS, DETAILS, SCHEDULES & SPECIFICATIONS FOR :
i. SPRINKLER INSTALLATION
ii. AUTOMATIC FIRE DETECTION SYSTEMS
iii. AIR CONDITIONING SYSTEM & DISTRIBUTION (HVAC)
iv. EMERGENCY LIGHTING
v. PRIMARY WIRING DESIGN & DISTRIBUTION
- ALL WORK IS TO BE CARRIED OUT STRICTLY IN ACCORDANCE WITH IS STANDARDS (WHERE APPLICABLE) & BEST TRADE PRACTICES. ALL WORK MUST SATISFY THE REQUIREMENTS OF THE LOCAL AUTHORITIES.
- WHITE WATER DESIGN STUDIO TO APPROVE ALL CONTRACTORS' SETTINGS OUT & ALL CO-ORDINATION SHOP DRAWINGS PRIOR TO ALL MANUFACTURERS, CONTRACTORS, INSTALLERS & SPECIALISTS TO BE RESPONSIBLE FOR ENSURING THAT ALL OF THEIR COMMENCEMENT OF INSTALLATION
- WORKS FULLY COMPLY WITH THE REQUIREMENTS OF THE LOCAL AUTHORITIES & FIRE DEPARTMENT & THAT ALL SAFETY STANDARDS ARE MET THROUGHOUT.
- ALL FIT-OUT CONTRACTORS & SPECIALISTS TO PREPARE FULL SHOP DRAWINGS WITH SPECIFIC REFERENCE TO SITE CONDITIONS FOR WHITE WATER DESIGN STUDIO APPROVAL PRIOR TO MANUFACTURE & INSTALLATION AS APPROPRIATE TO THEIR TASK.

KEY PLAN :



AMMENDMENTS :

S.NO.	REV. DATE	DESCRIPTION

DRAWING NO :	24
--------------	-----------

DRAWING TITLE :	LIGHTING LAYOUT
-----------------	------------------------

LOCATION :	LEVEL F-WEST-HYDERABAD
------------	------------------------

DATE :	21-02-2024
SCALE :	NTS
DRN. BY :	PRATIKSHA
CHKD. BY :	QAISAR

PROJECT :	PH- LEVEL F- WEST-HYDERABAD
-----------	-----------------------------

CLIENT :	TRAVEL FOOD SERVICES
----------	----------------------



HEAD OFFICE:-
Anchorage, off Govandi Station Rd
Near Amarnath Patil Ground, Govandi-(E)
Mumbai 400 088
TEL: +91 22 6740 7640.
Email: studio@whitewaterdesign.in