

# 08. BOH INTERIOR ZONING



## 08.04 BOH EQUIPMENT CUTSHEETS

### 08. Mop cabinet

#### FEATURES:

- 16" x 20" x 12" Sink Bowl with drain.
- Louvered Side Panels for ventilation.
- Single Left-Hinged Door.
- Fixed Stainless Steel Utility Shelf.
- 2 Mop Holders (1 on each side).

#### CONSTRUCTION:

- All TIG welded.
- Welded areas blended to match adjacent surfaces and to a satin finish.

#### MATERIAL:

- 16 gauge type "304" Series Sink Bowl.
- 18 gauge type "304" Series Sink Bowl Apron.
- 18 gauge type "430" Series Stainless Steel Cabinet.

#### OPTIONS:

- TA-46 Door Lock.
- K-94-CAB 18 gauge type "304" Stainless Steel Cabinet Upgrade.
- K-94-BACK Add Stainless Steel Back Panel.
- K-472 Add 8" O.C. Faucet Holes for Service Faucet. (Must provide faucet hole height location).
- K-240 Service Faucet.
- Standard Right-Hand Door Swing.
- (Please Specify for Left-Hand Door Swing when ordering).

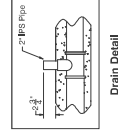
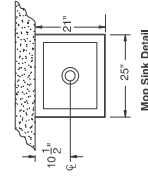
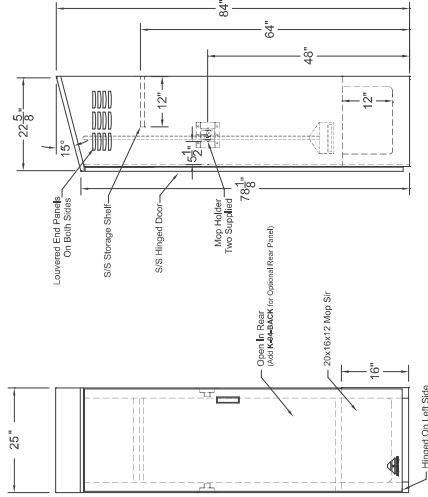
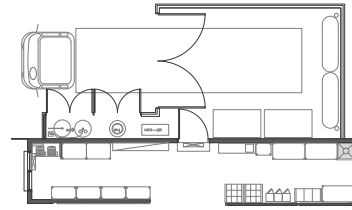

Cabinet Includes Floor Mop Sink

**MEDIA REQUIREMENTS:** Cold water/ Hot water/ Sewerage  
**COLD WATER:** 1/2" on the wall + 25" (60 cm)  
**HOT WATER:** 1/2" on the wall + 25" (60 cm)  
**SEWERAGE:** 2" on the floor + 2 3/4" (+7 cm)  
**DIMENSIONS L x D x H:** 25" x 22 5/8" x 80"  
**SUPPLIER / MANUFACTURER:** LOCAL SUPPLIER/Advance Tabco.  
**MODEL:** MOP SINK CABINET 9-OPC-84

