

ELECTRICAL LOW VOLTAGE SYSTEM LEGEND		
SYMBOL	DESCRIPTION	QTY
	DOME CCTV CAMERA – IP67 CEILING MOUNT	07
	DOME CCTV CAMERA – IP67 CEILING MOUNT (ONLY CABLING BETWEEN THE CAMERA AND MUTOA)	02
	DVR FOR CCTV	01
	CCTV CABLE	--

- NOTES**
- ALL DIMENSIONS & LEVEL ARE IN "MM" OR OTHERWISE MENTIONED.
 - CCTV TO BE FIXED TO CEILING COORDINATING WITH LIGHTS, SPRINKLERS AND DETECTORS FOR AVOID CLASHES.
 - THE CABLE ROUTING SHOWN IN THE DIAGRAM IS INDICATIVE SCHEMATIC ONLY. ACTUAL ROUTING IS TO BE DONE AS PER SITE CONDITION AND ALSO COORDINATE WITH OTHER SERVICES.
 - ONLY FIXED TYPE CAMERA SHALL BE USED. NO PAN / TILT TYPE CAMERA IS ALLOWED.
 - CAT6 CABLE OF BELDEN MAKE FOR EPOS CAMERA SHALL BE BROUGHT TO THE LOCATION ABOVE POS.
 - IT CABLE TO BE TERMINATED WITH IO AND NEED TO LEFT AT CEILING HEIGHT FOR FIXING EPOS CAMERA. (THIS WILL BE DONE BY GMR IT TEAM).
 - BACKUP SHOULD BE 45 DAYS.

ALL DIMENSIONS MUST BE CHECKED ON SITE. INFORM THE ENGINEER OF ANY DISCREPANCIES PRIOR TO CONSTRUCTION.

NOTES:
IRRESPECTIVE OF THE DRAWING(S), IT IS THE CONTRACTOR'S OBLIGATION AND RESPONSIBILITY THAT SHALL BE EXECUTED AND COMPLETED IN ACCORDANCE TO THE SPECIFICATION, DRAWING(S) AS WELL AS REQUIREMENT. THE SAID DRAWING(S) SHALL NOT RELIEVE CONTRACTOR FROM ITS OBLIGATION UNDER THE CONTRACT AND IN PARTICULAR FROM ITS RESPONSIBILITY IN RELATION TO THE INSTALLATION MATERIALS AND WORKMANSHIP AND WHERE RELEVANT FROM A DUTY TO SEEK APPROVAL FROM THE COMPETENT AUTHORITY.

REV	DATE	DESCRIPTION	TT	SM	DSN	CHK
C05	12.10.24	GOOD FOR CONSTRUCTION				



PROJECT
CARLSJR FF018
GMR INTERNATIONAL
AIRPORT LIMITED,
HYDERABAD

DRAWING TITLE
CCTV LAYOUT

SCALE 1:75 DATE 12.10.24 DESIGN TT A3 SHEET

STATUS
GOOD FOR CONSTRUCTION

ORG	PROJECT NO	DRAWING TYPE	NUMBER	REV
TFS	0000	ELEC	E501	C05

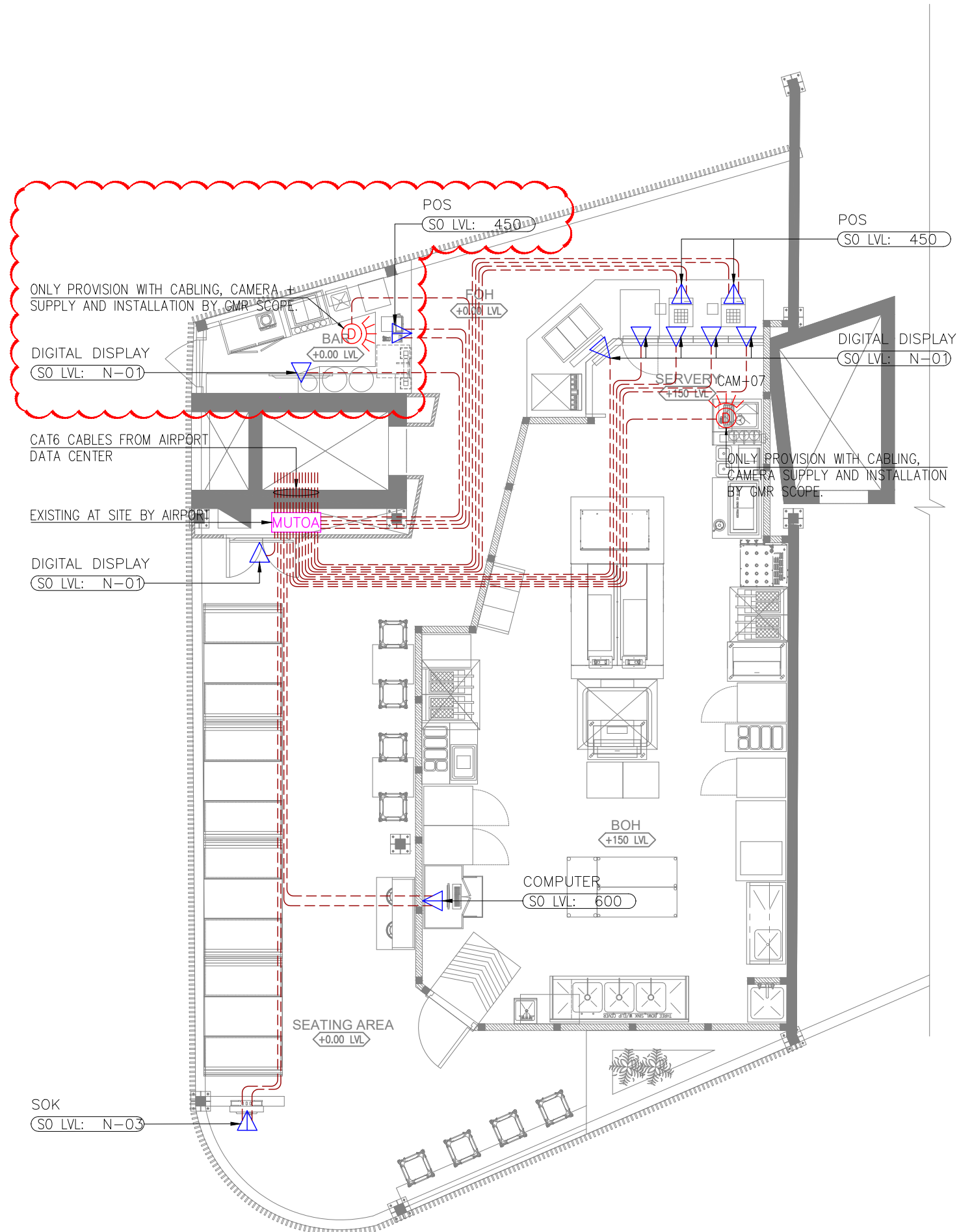

ELECTRICAL LOW VOLTAGE SYSTEM LEGEND		
SYMBOL	DESCRIPTION	QTY
▽	SINGLE DATA OUTLET (RJ45)	07
▽	DUAL DATA OUTLET (RJ45)	05
☉	DOME CCTV CAMERA – IP67 CEILING MOUNT (ONLY CABLING BETWEEN THE CAMERA AND MUTOA)	02
MUTOA	MULTI USER TELECOMMUNICATION OUTLET ASSEMBLY (DATA NETWORK) (EXISTING AT SITE BY AIRPORT)	--
---	DATA SYSTEM CABLE	--

NOTES

- ALL DIMENSIONS & LEVEL ARE IN "MM" OR OTHERWISE MENTIONED.
- CONTRACTOR TO CHECK & CONFIRM THE NUMBER OF CAT6 CABLES / DATA POINTS AVAILABLE AT MUTOA BOX AT SITE TO MEET PROJECT REQUIREMENTS.
- ALL DATA CABLES TO BE BELDEN MAKE (PART CODE-7834ANC OR SAME SPECIFIED BY AIRPORT).
- ALL SWITCH / SOCKET / DATA OUTLET PLATE COLOUR / FINISH TO BE MATCH WITH ARCHITECTURAL LAYOUT & ARCHITECT APPROVAL TO BE TAKEN PRIOR TO PRODUCT PROCUREMENT.
- N-01: SOCKET OUTLETS TO BE FIXED WITH TV INSTALLATION FRAME / ROD.
- N-03: SOCKET FIXING TO BE COORDINATE WITH SOK.

ALL DIMENSIONS MUST BE CHECKED ON SITE.
INFORM THE ENGINEER OF ANY DISCREPANCIES PRIOR TO CONSTRUCTION.

NOTES:
IRRESPECTIVE OF THE DRAWING(S), IT IS THE CONTRACTOR'S OBLIGATION AND RESPONSIBILITY THAT SHALL BE EXECUTED AND COMPLETED IN ACCORDANCE TO THE SPECIFICATION, DRAWING(S) AS WELL AS REQUIREMENT. THE SAID DRAWING(S) SHALL NOT RELIEVE CONTRACTOR FROM ITS OBLIGATION UNDER THE CONTRACT AND IN PARTICULAR FROM ITS RESPONSIBILITY IN RELATION TO THE INSTALLATION MATERIALS AND WORKMANSHIP AND WHERE RELEVANT FROM A DUTY TO SEEK APPROVAL FROM THE COMPETENT AUTHORITY.

C05 12.10.24 GOOD FOR CONSTRUCTION TT SM
REV DATE DESCRIPTION DSN CHK



PROJECT
CARLSJR FF018
GMR INTERNATIONAL
AIRPORT LIMITED,
HYDERABAD

DRAWING TITLE
DATA LAYOUT

SCALE 1:75 DATE 12.10.24 DESIGN TT A3 SHEET

STATUS
GOOD FOR CONSTRUCTION

ORG PROJECT NO DRAWING TYPE NUMBER REV
TFS 0000 ELEC E502 C05