

SPRINKLER LEGEND	
SYMBOL	DESCRIPTION
	SPRINKLER PIPE
	PENDANT SPRINKLER 79 DEGREE C
	UPRIGHT SPRINKLER 68 DEGREE C
	PENDANT SPRINKLER 68 DEGREE C
	25MM FLEXIBLE SPRINKLER DROP
	DRAIN VALVE
	DRAIN PIPE
	PIPE REDUCER
	FLOW SWITCH
	PRESSURE GAUGE
	TAMPER SWITCH
	TAMPER SWITCH

- NOTE:**
- PIPES & FITTINGS - IS 1239 Part -1 Class "C" Heavy.
 - SPRINKLER PIPES BOTTOM (1372mm) FROM FINISH FLOOR LEVEL.
 - PRESSURE GAUGE (0-18KG & GLYCERINE FILLED) TO BE INSTALLED NEAR INLET VALVE.
 - TAMPER SWITCH & FLOW SWITCH TO BE INSTALLED AT INLET VALVE & TO BE INTEGRATED TO FAS PANEL.
 - WHILE ROUTING SPRINKLER PIPE PLEASE FOLLOW HVAC DWG & OTHER SERVICES & OFFSET THE PIPE WHEREVER REQUIRED.
 - SUPERVISORY VALVE TO BE INTEGRATED WITH DIAL SYSTEM.

- NOTES :**
- THE COPYRIGHT OF THIS DRAWING REMAINS WITH WHITE WATER DESIGN STUDIO AND IT MAY NOT BE REPRODUCED IN ANY WHICH MANNER WITHOUT PRIOR WRITTEN CONSENT.
- FIGURED DIMENSIONS ARE TO BE USED IN PREFERENCES TO SCALED SIZES. ALL DIMENSIONS MUST BE CHECKED BEFORE COMMENCING WORK ON SITE.
 - THIS DRAWINGS TO BE READ IN CONJUNCTION WITH ALL OTHER RELEVANT DRAWINGS.
 - ALL PROPOSED WORKS TO BE CARRIED OUT IN ACCORDANCE WITH TECHNICAL SPECIFICATIONS AND SCHEDULES MENTIONED FOR INTERIOR WORKS.
 - READ THIS DRAWING IN CONJUNCTION WITH ALL CONSULTANTS' & SPECIALISTS' DRAWINGS, DETAILS, SCHEDULES & SPECIFICATIONS FOR :
i. SPRINKLER INSTALLATION
ii. AUTOMATIC FIRE DETECTION SYSTEMS
iii. AIR CONDITIONING SYSTEM & DISTRIBUTION (HVAC)
iv. EMERGENCY LIGHTING
v. PRIMARY WIRING DESIGN & DISTRIBUTION
 - ALL WORK IS TO BE CARRIED OUT STRICTLY IN ACCORDANCE WITH IS STANDARDS (WHERE APPLICABLE) & BEST TRADE PRACTICES. ALL WORK MUST SATISFY THE REQUIREMENTS OF THE LOCAL AUTHORITIES.
 - WHITE WATER DESIGN STUDIO TO APPROVE ALL CONTRACTORS' SETTINGS OUT & ALL CO-ORDINATION SHOP DRAWINGS PRIOR TO ALL MANUFACTURERS, CONTRACTORS, INSTALLERS & SPECIALISTS TO BE RESPONSIBLE FOR ENSURING THAT ALL OF THEIR COMMENCEMENT OF INSTALLATION
 - WORKS FULLY COMPLY WITH THE REQUIREMENTS OF THE LOCAL AUTHORITIES & FIRE DEPARTMENT & THAT ALL SAFETY STANDARDS ARE MET THROUGHOUT.
 - ALL FIT-OUT CONTRACTORS & SPECIALISTS TO PREPARE FULL SHOP DRAWINGS WITH SPECIFIC REFERENCE TO SITE CONDITIONS FOR WHITE WATER DESIGN STUDIO APPROVAL PRIOR TO MANUFACTURE & INSTALLATION AS APPROPRIATE TO THEIR TASK.

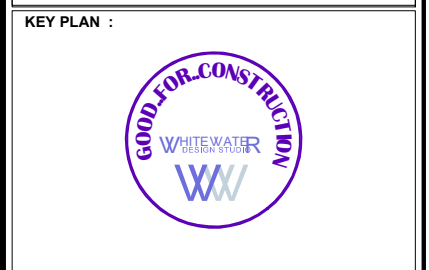

AMMENDMENTS :

S.NO.	REV.DATE	DESCRIPTION
1.	30.11.2023	GFC
2.	07.12.2023	R1.

DRAWING NO : **KFC-AIR-DL-PLU-SPL-01** R1

DRAWING TITLE : **SPRINKLER LAYOUT. (BELOW STRUCTURE)**

LOCATION : **DELHI**

DATE : 07.12.2023
SCALE : NTS
DRN. BY : VAIBHAV
CHKD. BY : RITESH

PROJECT : **KFC, AIRPORT @ DELHI.**

CLIENT : **TRAVEL FOOD SERVICE**

WHITE WATER DESIGN STUDIO

WW

HEAD OFFICE:-
Anchorage, off Govandi Station Rd
Near Amarnath Patil Ground, Govandi-(E)
Mumbai 400 088
TEL: +91 22 6740 7640.
Email: studio@whitewaterdesign.in

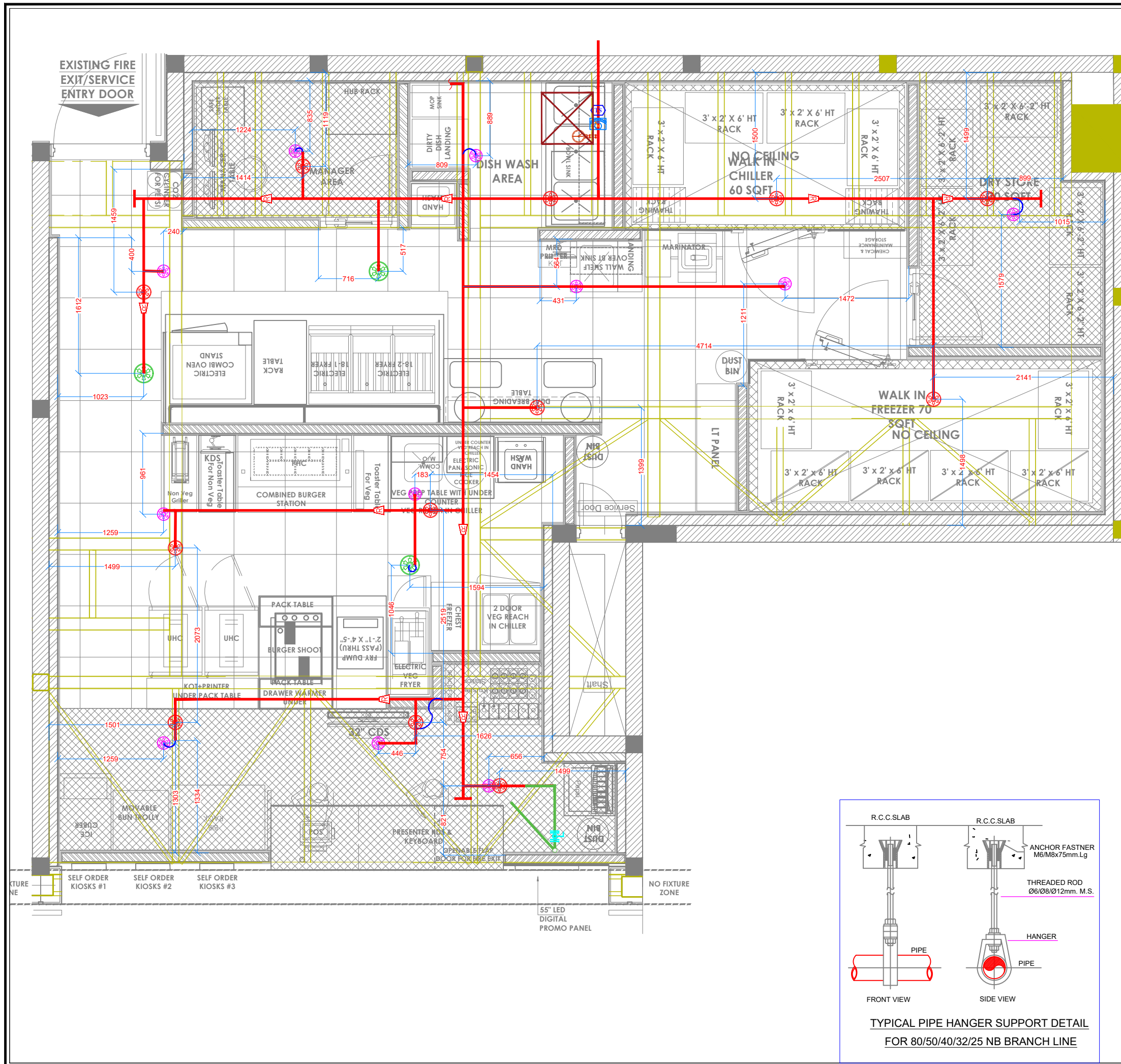

- NOTES :**
- THE COPYRIGHT OF THIS DRAWING REMAINS WITH WHITE WATER DESIGN STUDIO AND IT MAY NOT BE REPRODUCED IN ANY WHICH MANNER WITHOUT PRIOR WRITTEN CONSENT.
 - FIGURED DIMENSIONS ARE TO BE USED IN PREFERENCES TO SCALED SIZES. ALL DIMENSIONS MUST BE CHECKED BEFORE COMMENCING WORK ON SITE.
 - THIS DRAWINGS TO BE READ IN CONJUNCTION WITH ALL OTHER RELEVANT DRAWINGS.
 - ALL PROPOSED WORKS TO BE CARRIED OUT IN ACCORDANCE WITH TECHNICAL SPECIFICATIONS AND SCHEDULES MENTIONED FOR INTERIOR WORKS.
 - READ THIS DRAWING IN CONJUNCTION WITH ALL CONSULTANTS' & SPECIALISTS' DRAWINGS, DETAILS, SCHEDULES & SPECIFICATIONS FOR :
 - SPRINKLER INSTALLATION
 - AUTOMATIC FIRE DETECTION SYSTEMS
 - AIR CONDITIONING SYSTEM & DISTRIBUTION (HVAC)
 - EMERGENCY LIGHTING
 - PRIMARY WIRING DESIGN & DISTRIBUTION
 - ALL WORK IS TO BE CARRIED OUT STRICTLY IN ACCORDANCE WITH IS STANDARDS (WHERE APPLICABLE) & BEST TRADE PRACTICES. ALL WORK MUST SATISFY THE REQUIREMENTS OF THE LOCAL AUTHORITIES.
 - WHITE WATER DESIGN STUDIO TO APPROVE ALL CONTRACTORS' SETTINGS OUT & ALL CO-ORDINATION SHOP DRAWINGS PRIOR TO ALL MANUFACTURERS, CONTRACTORS, INSTALLERS & SPECIALISTS TO BE RESPONSIBLE FOR ENSURING THAT ALL OF THEIR COMMENCEMENT OF INSTALLATION
 - WORKS FULLY COMPLY WITH THE REQUIREMENTS OF THE LOCAL AUTHORITIES & FIRE DEPARTMENT & THAT ALL SAFETY STANDARDS ARE MET THROUGHOUT.
 - ALL FIT-OUT CONTRACTORS & SPECIALISTS TO PREPARE FULL SHOP DRAWINGS WITH SPECIFIC REFERENCE TO SITE CONDITIONS FOR WHITE WATER DESIGN STUDIO APPROVAL PRIOR TO MANUFACTURE & INSTALLATION AS APPROPRIATE TO THEIR TASK.

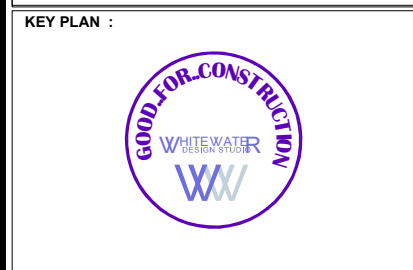

AMENDMENTS :

S.NO.	REV. DATE	DESCRIPTION
1.	30.11.2023	GFC
2.	07.12.2023	R1.

DRAWING NO : **KFC-AIR-DL-PLU-SPCL-02 R1**

DRAWING TITLE : **SPRINKLER DIMENSION LAYOUT. (BELOW STRUCTURE)**

LOCATION : **DELHI**

DATE : 07.12.2023
 SCALE : NTS
 DRN. BY : VAIBHAV
 CHKD. BY : RITESH

PROJECT : **KFC, AIRPORT @ DELHI.**

CLIENT : **TRAVEL FOOD SERVICE**



HEAD OFFICE:-
 Anchorage, off Govandi Station Rd
 Near Amarnath Patil Ground, Govandi-(E)
 Mumbai 400 088
 TEL: +91 22 6740 7640.
 Email: studio@whitewaterdesign.in

SPRINKLER LEGEND

SYMBOL	DESCRIPTION
	SPRINKLER PIPE
	PENDANT SPRINKLER 79 DEGREE C
	UPRIGHT SPRINKLER 68 DEGREE C
	PENDANT SPRINKLER 68 DEGREE C
	25MM FLEXIBLE SPRINKLER DROP
	DRAIN VALVE
	DRAIN PIPE
	PIPE REDUCER
	FLOW SWITCH
	PRESSURE GAUGE
	TAMPER SWITCH
	TAMPER SWITCH

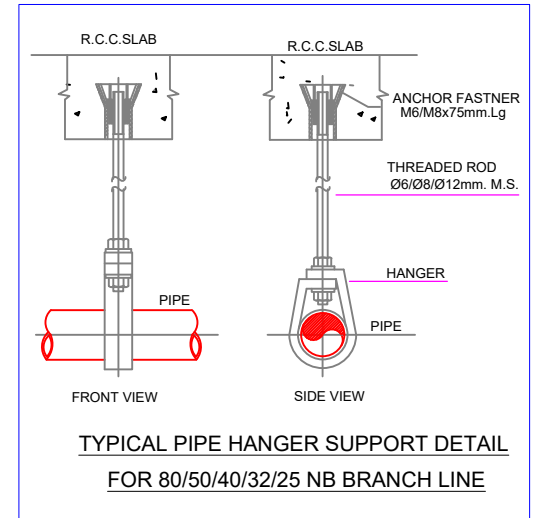

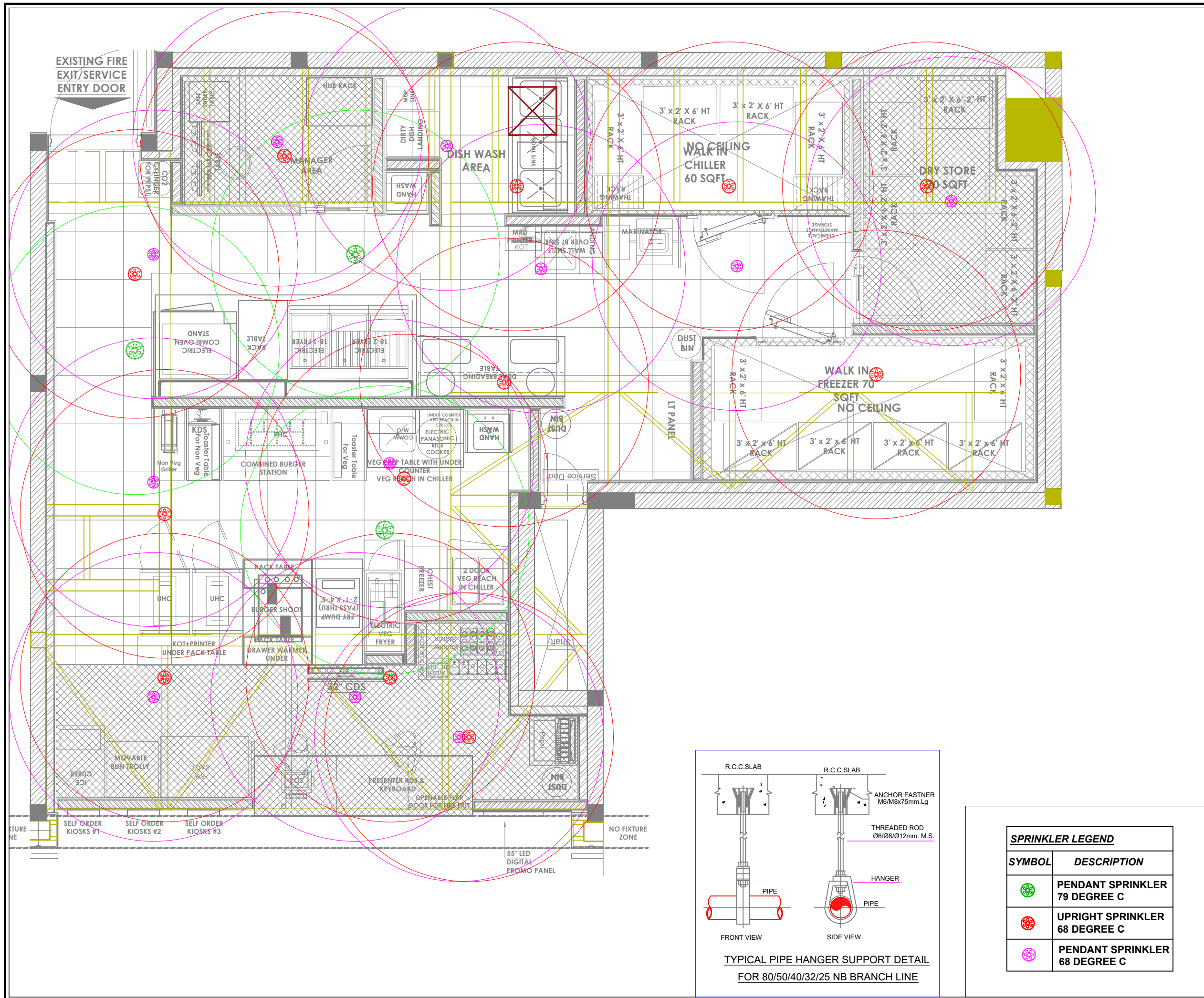

- NOTES :**
- THE COPYRIGHT OF THIS DRAWING REMAINS WITH WHITE WATER DESIGN STUDIO AND IT MAY NOT BE REPRODUCED IN ANY WHICH MANNER WITHOUT PRIOR WRITTEN CONSENT.
 - FIGURED DIMENSIONS ARE TO BE USED IN PREFERENCES TO SCALED SIZES. ALL DIMENSIONS MUST BE CHECKED BEFORE COMMENCING WORK ON SITE.
 - THIS DRAWINGS TO BE READ IN CONJUNCTION WITH ALL OTHER RELEVANT DRAWINGS.
 - ALL PROPOSED WORKS TO BE CARRIED OUT IN ACCORDANCE WITH TECHNICAL SPECIFICATIONS AND SCHEDULES MENTIONED FOR INTERIOR WORKS.
 - READ THIS DRAWING IN CONJUNCTION WITH ALL CONSULTANTS' & SPECIALISTS' DRAWINGS, DETAILS, SCHEDULES & SPECIFICATIONS FOR :
 - SPRINKLER INSTALLATION
 - AUTOMATIC FIRE DETECTION SYSTEMS
 - AIR CONDITIONING SYSTEM & DISTRIBUTION (HVAC)
 - EMERGENCY LIGHTING
 - PRIMARY WIRING DESIGN & DISTRIBUTION
 - ALL WORK IS TO BE CARRIED OUT STRICTLY IN ACCORDANCE WITH IS STANDARDS (WHERE APPLICABLE) & BEST TRADE PRACTICES. ALL WORK MUST SATISFY THE REQUIREMENTS OF THE LOCAL AUTHORITIES.
 - WHITE WATER DESIGN STUDIO TO APPROVE ALL CONTRACTORS' SETTINGS OUT & ALL CO-ORDINATION SHOP DRAWINGS PRIOR TO ALL MANUFACTURERS, CONTRACTORS, INSTALLERS & SPECIALISTS TO BE RESPONSIBLE FOR ENSURING THAT ALL OF THEIR COMMENCEMENT OF INSTALLATION
 - WORKS FULLY COMPLY WITH THE REQUIREMENTS OF THE LOCAL AUTHORITIES & FIRE DEPARTMENT & THAT ALL SAFETY STANDARDS ARE MET THROUGHOUT.
 - ALL FIT-OUT CONTRACTORS & SPECIALISTS TO PREPARE FULL SHOP DRAWINGS WITH SPECIFIC REFERENCE TO SITE CONDITIONS FOR WHITE WATER DESIGN STUDIO APPROVAL PRIOR TO MANUFACTURE & INSTALLATION AS APPROPRIATE TO THEIR TASK.

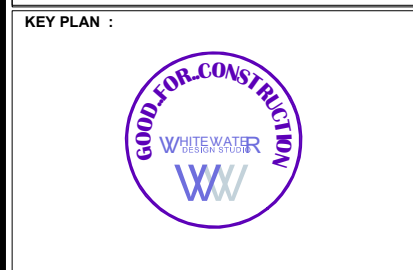

AMENDMENTS :

S.NO.	REV. DATE	DESCRIPTION
1.	30.11.2023	GFC
2.	07.12.2023	R1.

DRAWING NO : **KFC-AIR-DL-PLU-SPCL-03 R1**

DRAWING TITLE : **SPRINKLER COVERAGE LAYOUT. (BELOW STRUCTURE)**

LOCATION : **DELHI**

DATE : 07.12.2023
 SCALE : NTS
 DRN. BY : VAIBHAV
 CHKD. BY : RITESH

PROJECT : **KFC, AIRPORT @ DELHI.**

CLIENT : **TRAVEL FOOD SERVICE**



HEAD OFFICE:-
 Anchorage, off Govandi Station Rd
 Near Amarnath Patil Ground, Govandi-(E)
 Mumbai 400 088
 TEL: +91 22 6740 7640.
 Email: studio@whitewaterdesign.in

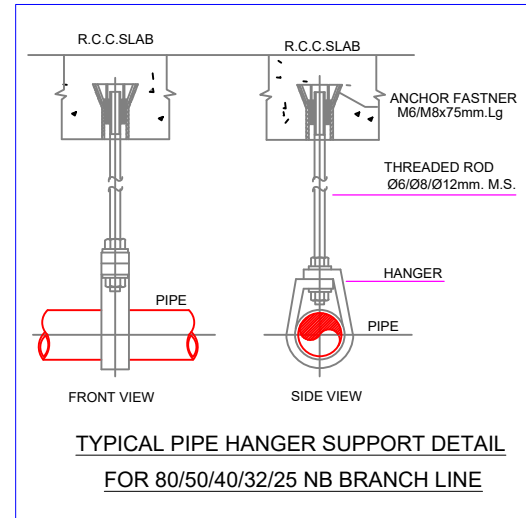

SPRINKLER LEGEND

SYMBOL	DESCRIPTION
	PENDANT SPRINKLER 79 DEGREE C
	UPRIGHT SPRINKLER 68 DEGREE C
	PENDANT SPRINKLER 68 DEGREE C

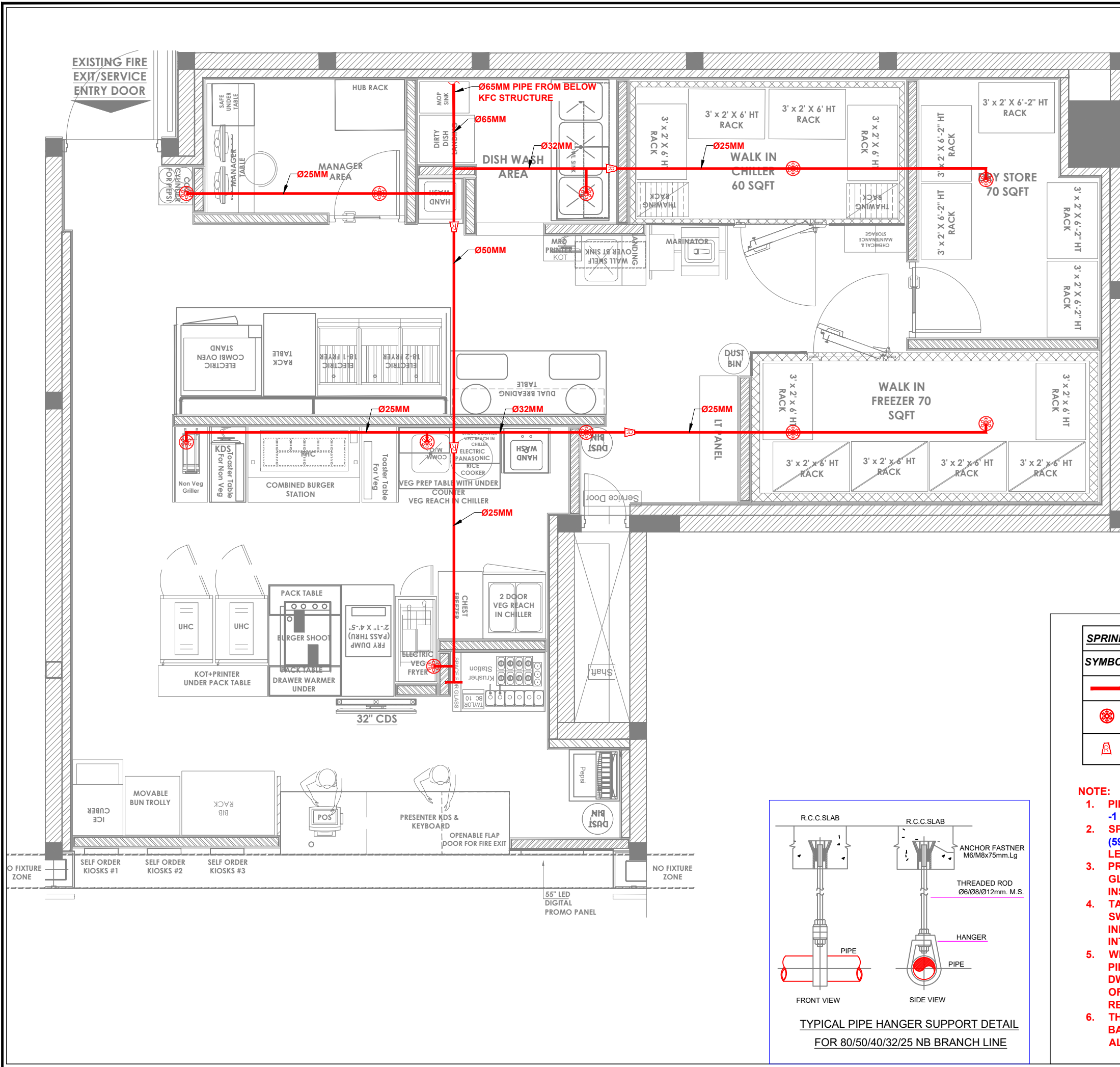

- NOTES :**
- THE COPYRIGHT OF THIS DRAWING REMAINS WITH WHITE WATER DESIGN STUDIO AND IT MAY NOT BE REPRODUCED IN ANY WHICH MANNER WITHOUT PRIOR WRITTEN CONSENT.
 - FIGURED DIMENSIONS ARE TO BE USED IN PREFERENCES TO SCALED SIZES. ALL DIMENSIONS MUST BE CHECKED BEFORE COMMENCING WORK ON SITE.
 - THIS DRAWINGS TO BE READ IN CONJUNCTION WITH ALL OTHER RELEVANT DRAWINGS.
 - ALL PROPOSED WORKS TO BE CARRIED OUT IN ACCORDANCE WITH TECHNICAL SPECIFICATIONS AND SCHEDULES MENTIONED FOR INTERIOR WORKS.
 - READ THIS DRAWING IN CONJUNCTION WITH ALL CONSULTANTS' & SPECIALISTS' DRAWINGS, DETAILS, SCHEDULES & SPECIFICATIONS FOR :
 - SPRINKLER INSTALLATION
 - AUTOMATIC FIRE DETECTION SYSTEMS
 - AIR CONDITIONING SYSTEM & DISTRIBUTION (HVAC)
 - EMERGENCY LIGHTING
 - PRIMARY WIRING DESIGN & DISTRIBUTION
 - ALL WORK IS TO BE CARRIED OUT STRICTLY IN ACCORDANCE WITH IS STANDARDS (WHERE APPLICABLE) & BEST TRADE PRACTICES. ALL WORK MUST SATISFY THE REQUIREMENTS OF THE LOCAL AUTHORITIES.
 - WHITE WATER DESIGN STUDIO TO APPROVE ALL CONTRACTORS' SETTINGS OUT & ALL CO-ORDINATION SHOP DRAWINGS PRIOR TO BE RESPONSIBLE FOR ENSURING THAT ALL OF THEIR COMMENCEMENT OF INSTALLATION
 - WORKS FULLY COMPLY WITH THE REQUIREMENTS OF THE LOCAL AUTHORITIES & FIRE DEPARTMENT & THAT ALL SAFETY STANDARDS ARE MET THROUGHOUT.
 - ALL FIT-OUT CONTRACTORS & SPECIALISTS TO PREPARE FULL SHOP DRAWINGS WITH SPECIFIC REFERENCE TO SITE CONDITIONS FOR WHITE WATER DESIGN STUDIO APPROVAL PRIOR TO MANUFACTURE & INSTALLATION AS APPROPRIATE TO THEIR TASK.

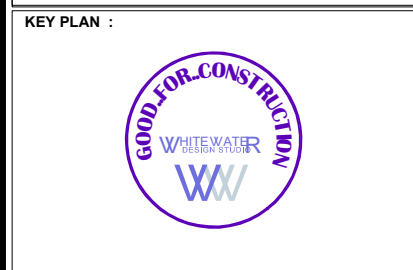

AMMENDMENTS :

S.NO.	REV.DATE	DESCRIPTION
1.	30.11.2023	GFC
2.	07.12.2023	R1.

DRAWING NO : **KFC-AIR-DL-PLU-SPL-04** **R1**

DRAWING TITLE : **SPRINKLER LAYOUT. (ABOVE STRUCTURE)**

LOCATION : **DELHI**

DATE : 07.12.2023
 SCALE : NTS
 DRN. BY : VAIBHAV
 CHKD. BY : RITESH

PROJECT : **KFC, AIRPORT @ DELHI.**

CLIENT : **TRAVEL FOOD SERVICE**



HEAD OFFICE:-
 Anchorage, off Govandi Station Rd
 Near Amarnath Patil Ground, Govandi-(E)
 Mumbai 400 088
 TEL: +91 22 6740 7640.
 Email: studio@whitewaterdesign.in

SPRINKLER LEGEND

SYMBOL	DESCRIPTION
	SPRINKLER PIPE
	UPRIGHT SPRINKLER 68 DEGREE C
	PIPE REDUCER

- NOTE:**
- PIPES & FITTINGS - IS 1239 Part -1 Class "C" Heavy.
 - SPRINKLER PIPES BOTTOM (5913mm) FROM FINISH FLOOR LEVEL.
 - PRESSURE GAUGE (0-18KG & GLYCERINE FILLED) TO BE INSTALLED NEAR INLET VALVE.
 - TAMPER SWITCH & FLOW SWITCH TO BE INSTALLED AT INLET VALVE & TO BE INTEGRATED TO FAS PANEL.
 - WHILE ROUTING SPRINKLER PIPE PLEASE FOLLOW HVAC DWG & OTHER SERVICES & OFFSET THE PIPE WHEREVER REQUIRED.
 - THE MINIMUM PRESSURE OF 0.5 BAR SHALL BE MAINTAINED AT ALL SPRINKLER POINTS.

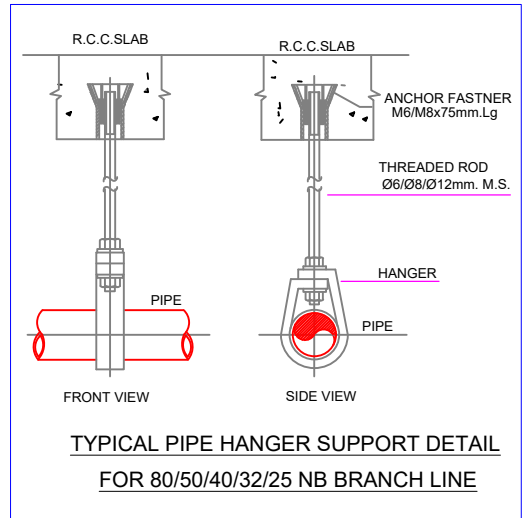

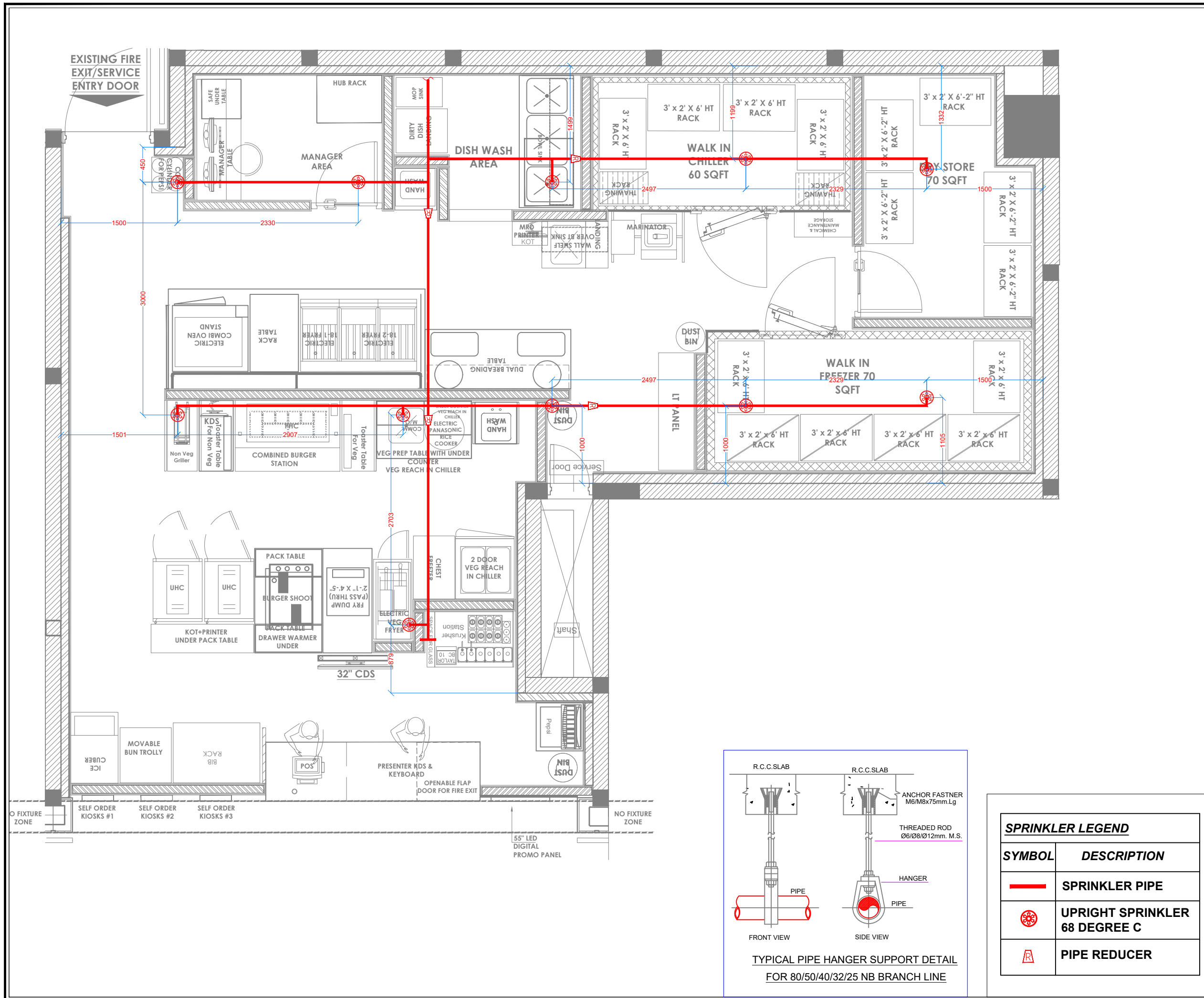

- NOTES :**
- THE COPYRIGHT OF THIS DRAWING REMAINS WITH WHITE WATER DESIGN STUDIO AND IT MAY NOT BE REPRODUCED IN ANY WHICH MANNER WITHOUT PRIOR WRITTEN CONSENT.
 - FIGURED DIMENSIONS ARE TO BE USED IN PREFERENCES TO SCALED SIZES. ALL DIMENSIONS MUST BE CHECKED BEFORE COMMENCING WORK ON SITE.
 - THIS DRAWINGS TO BE READ IN CONJUNCTION WITH ALL OTHER RELEVANT DRAWINGS.
 - ALL PROPOSED WORKS TO BE CARRIED OUT IN ACCORDANCE WITH TECHNICAL SPECIFICATIONS AND SCHEDULES MENTIONED FOR INTERIOR WORKS.
 - READ THIS DRAWING IN CONJUNCTION WITH ALL CONSULTANTS' & SPECIALISTS' DRAWINGS, DETAILS, SCHEDULES & SPECIFICATIONS FOR :
 - SPRINKLER INSTALLATION
 - AUTOMATIC FIRE DETECTION SYSTEMS
 - AIR CONDITIONING SYSTEM & DISTRIBUTION (HVAC)
 - EMERGENCY LIGHTING
 - PRIMARY WIRING DESIGN & DISTRIBUTION
 - ALL WORK IS TO BE CARRIED OUT STRICTLY IN ACCORDANCE WITH IS STANDARDS (WHERE APPLICABLE) & BEST TRADE PRACTICES. ALL WORK MUST SATISFY THE REQUIREMENTS OF THE LOCAL AUTHORITIES.
 - WHITE WATER DESIGN STUDIO TO APPROVE ALL CONTRACTORS' SETTINGS OUT & ALL CO-ORDINATION SHOP DRAWINGS PRIOR TO ALL MANUFACTURERS, CONTRACTORS, INSTALLERS & SPECIALISTS TO BE RESPONSIBLE FOR ENSURING THAT ALL OF THEIR COMMENCEMENT OF INSTALLATION
 - WORKS FULLY COMPLY WITH THE REQUIREMENTS OF THE LOCAL AUTHORITIES & FIRE DEPARTMENT & THAT ALL SAFETY STANDARDS ARE MET THROUGHOUT.
 - ALL FIT-OUT CONTRACTORS & SPECIALISTS TO PREPARE FULL SHOP DRAWINGS WITH SPECIFIC REFERENCE TO SITE CONDITIONS FOR WHITE WATER DESIGN STUDIO APPROVAL PRIOR TO MANUFACTURE & INSTALLATION AS APPROPRIATE TO THEIR TASK.

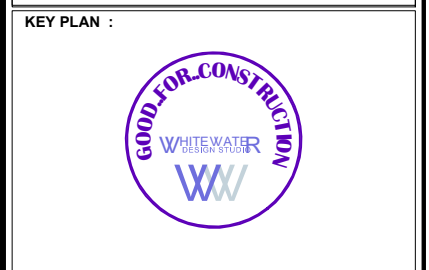

AMMENDMENTS :

S.NO.	REV.DATE	DESCRIPTION
1.	30.11.2023	GFC
2.	07.12.2023	R1.

DRAWING NO : **KFC-AIR-DL-PLU-SPL-05** **R1**

DRAWING TITLE : **SPRINKLER DIMENSION LAYOUT. (ABOVE STRUCTURE)**

LOCATION : **DELHI**

DATE : 07.12.2023
 SCALE : NTS
 DRN. BY : VAIBHAV
 CHKD. BY : RITESH

PROJECT : **KFC, AIRPORT @ DELHI.**

CLIENT : **TRAVEL FOOD SERVICE**



WW

HEAD OFFICE:-
 Anchorage, off Govandi Station Rd
 Near Amarnath Patil Ground, Govandi-(E)
 Mumbai 400 088
 TEL: +91 22 6740 7640.
 Email: studio@whitewaterdesign.in

SPRINKLER LEGEND

SYMBOL	DESCRIPTION
	SPRINKLER PIPE
	UPRIGHT SPRINKLER 68 DEGREE C
	PIPE REDUCER

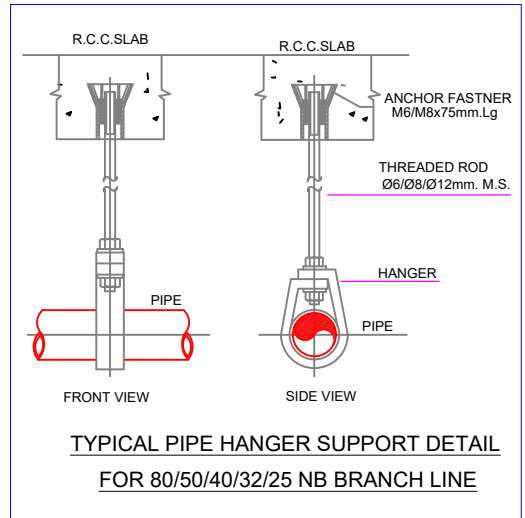

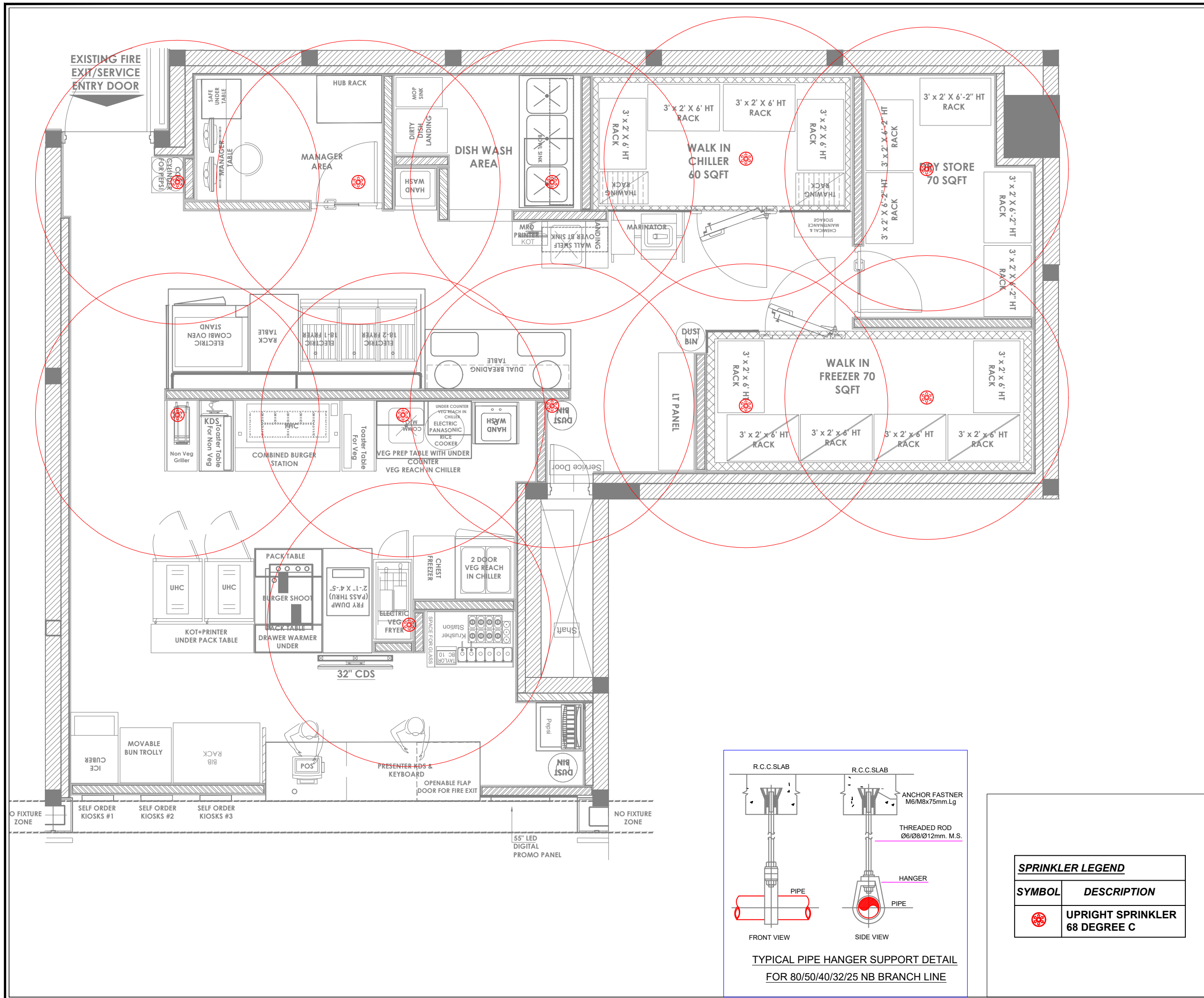

- NOTES :**
- THE COPYRIGHT OF THIS DRAWING REMAINS WITH WHITE WATER DESIGN STUDIO AND IT MAY NOT BE REPRODUCED IN ANY WHICH MANNER WITHOUT PRIOR WRITTEN CONSENT.
 - FIGURED DIMENSIONS ARE TO BE USED IN PREFERENCES TO SCALED SIZES. ALL DIMENSIONS MUST BE CHECKED BEFORE COMMENCING WORK ON SITE.
 - THIS DRAWINGS TO BE READ IN CONJUNCTION WITH ALL OTHER RELEVANT DRAWINGS.
 - ALL PROPOSED WORKS TO BE CARRIED OUT IN ACCORDANCE WITH TECHNICAL SPECIFICATIONS AND SCHEDULES MENTIONED FOR INTERIOR WORKS.
 - READ THIS DRAWING IN CONJUNCTION WITH ALL CONSULTANTS' & SPECIALISTS' DRAWINGS, DETAILS, SCHEDULES & SPECIFICATIONS FOR :
 - SPRINKLER INSTALLATION
 - AUTOMATIC FIRE DETECTION SYSTEMS
 - AIR CONDITIONING SYSTEM & DISTRIBUTION (HVAC)
 - EMERGENCY LIGHTING
 - PRIMARY WIRING DESIGN & DISTRIBUTION
 - ALL WORK IS TO BE CARRIED OUT STRICTLY IN ACCORDANCE WITH IS STANDARDS (WHERE APPLICABLE) & BEST TRADE PRACTICES. ALL WORK MUST SATISFY THE REQUIREMENTS OF THE LOCAL AUTHORITIES.
 - WHITE WATER DESIGN STUDIO TO APPROVE ALL CONTRACTORS' SETTINGS OUT & ALL CO-ORDINATION SHOP DRAWINGS PRIOR TO BE RESPONSIBLE FOR ENSURING THAT ALL OF THEIR COMMENCEMENT OF INSTALLATION
 - WORKS FULLY COMPLY WITH THE REQUIREMENTS OF THE LOCAL AUTHORITIES & FIRE DEPARTMENT & THAT ALL SAFETY STANDARDS ARE MET THROUGHOUT.
 - ALL FIT-OUT CONTRACTORS & SPECIALISTS TO PREPARE FULL SHOP DRAWINGS WITH SPECIFIC REFERENCE TO SITE CONDITIONS FOR WHITE WATER DESIGN STUDIO APPROVAL PRIOR TO MANUFACTURE & INSTALLATION AS APPROPRIATE TO THEIR TASK.



AMMENDMENTS :

S.NO.	REV.DATE	DESCRIPTION
1.	30.11.2023	GFC
2.	07.12.2023	R1.

DRAWING NO : **KFC-AIR-DL-PLU-SPCL-06 R1**

DRAWING TITLE : **SPRINKLER COVERAGE LAYOUT. (ABOVE STRUCTURE)**

LOCATION : **DELHI**

DATE : 07.12.2023
 SCALE : NTS
 DRN. BY : VAIBHAV
 CHKD. BY : RITESH

PROJECT : **KFC, AIRPORT @ DELHI.**

CLIENT : **TRAVEL FOOD SERVICE**



HEAD OFFICE:-
 Anchorage, off Govandi Station Rd
 Near Amarnath Patil Ground, Govandi-(E)
 Mumbai 400 088
 TEL: +91 22 6740 7640.
 Email: studio@whitewaterdesign.in

SPRINKLER LEGEND

SYMBOL	DESCRIPTION
	UPRIGHT SPRINKLER 68 DEGREE C

