

100MM. WIDE CONT.  
CURVED GRILLE

5# 400x100SAC  
150 CFM EACH  
350 FPM(TYP.)

1# 150x150 RAG

CHW/CSU/HI-STATIC  
CAP: 2.0TR 900 CFM  
SIZE: 946(W)x400(H)x816(D)  
ø25mm CHWS/R  
5.34gpm

AIR TIGHT PARTITION  
ABOVE FALSE CEILING.

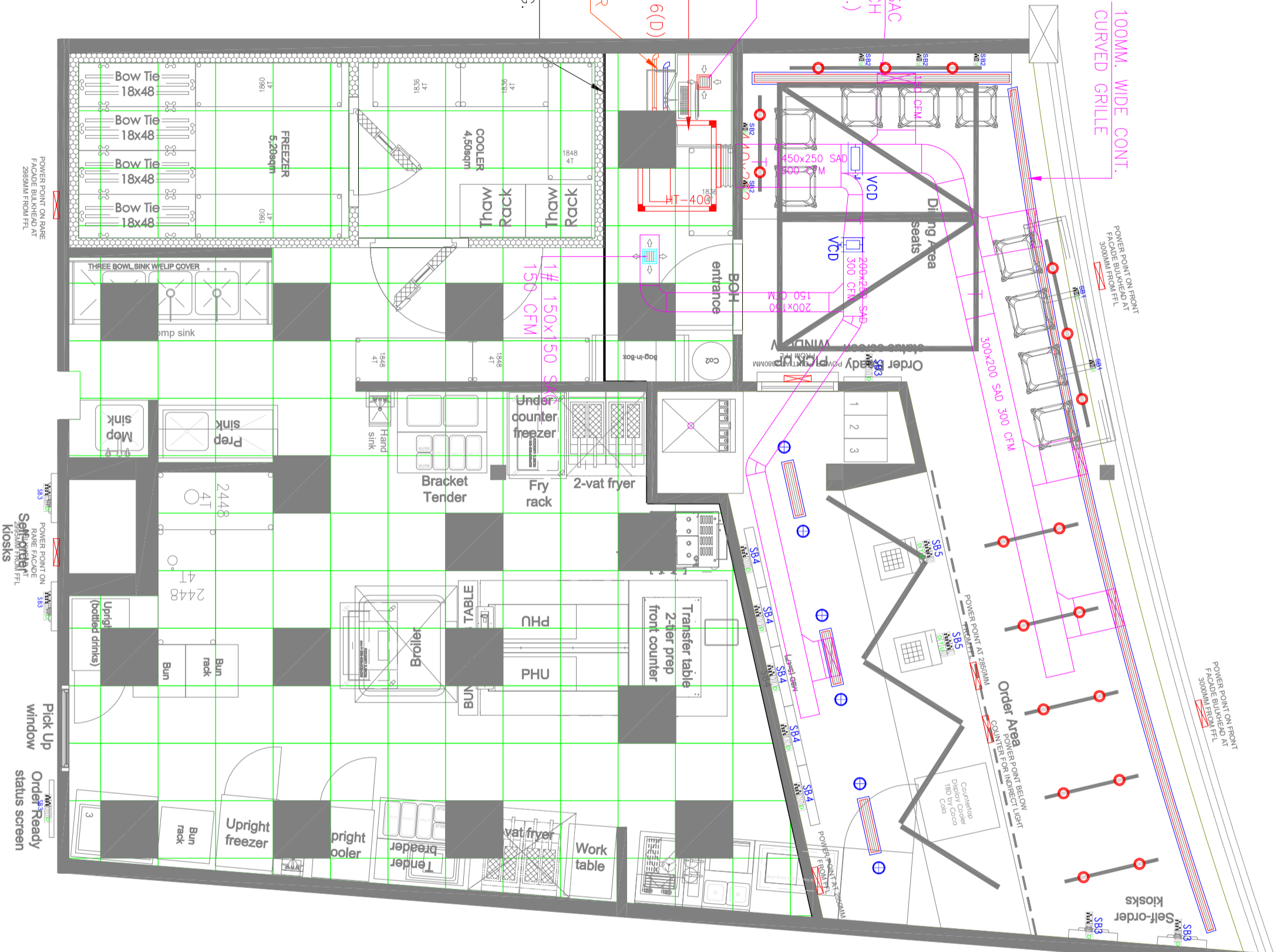

GENERAL NOTES:

1. G DUCT SHALL BE POWER COATED AND INSULATED FROM INSIDE
2. CABLE TRAY SHALL BE PERFORMED TYPE WITH BLACK POWDER
3. ALL DWS SHALL BE PAINTED IN BLACK CO. OR ENCLOSED/COVERED
4. REFRIGERANT PIPING SHALL BE WRAPPED WITH MIL CLOTH ABOVE AND BELOW REFRIGERANT PIPING SHALL BE PROVIDED WITH ENCLOSED/COVER
5. HEIGHT MENTIONED ARE AS PER INTERIOR LAYOUT NEED TO BE
6. DRAWING IF ARE TO BE PROVIDED WITH 8MM THICK NEOPRENE GASKET
7. TURNING/SPLITTER VANES SHALL BE PROVIDED WHEREVER SHOWN IN DRAWING
8. AVOID FLANGES DAMPERS ON ANY OTHER DUCTING JOINT BELOW BAW
9. THERE SHOULD NOT BE ANY ELECTRICAL, PANEL, EQUIPMENTS BELOW THE AC MACHINE IN SERVICE, ELECTRICAL AND UPS ROOM
10. PROVISION OF REMOVABLE OR OPERABLE CEILING FOR SERVICING AND MAINTENANCE OF AC UNIT IS SHOWN

NO	SYMBOL	DESCRIPTION
01		SUPPLY AIR DUCT RECTANGULAR TYPE
02		SUPPLY AIR DUCT ROUND TYPE
03		SUPPLY AIR DUCT WITH THERMAL INSULATION
04		SUPPLY AIR DUCT WITH ACOUSTIC INSULATION
05		LINEAR GRILLE
06		AIR TIGHT PARTITION
07		EX A GRILLE & DISC WALL
08		SA GRILLE
09		CHILLED WATER SUPPLY PIPE
10		CHILLED WATER RETURN PIPE
11		VOLUME CONTROL DAMPER
12		FIRE DAMPER
13		CEILING SUSPENDED AHU



D-16A\_CARL'S JR.

NO	DATE	DESCRIPTION	REMARK
02	01-02-2024	FOR APPROVAL	R1
01	09-12-2023	FOR APPROVAL	R0



1st Flr dwarka, 57 nagore road, sambharuz west, mumbai: 400 054  
T. el: 26482236 / 26482237



MEPTEK CONSULTANTS  
Complete MEP Design Solutions  
M12, 1st floor, Park Society, 400 007  
Vile Pagar East, Mumbai - 400 027  
mumbai@mepteconsultants.com

DATE	REVISION
27-02-2023	NORTH
27-02-2023	NORTH

DRAWING TITLE  
HVAC LAYOUT  
CARL'S JR.

DRG NO: LKO DSHA CARL'S JR. D-16A\_GFC-  
R0\_231212\_04

SCALE: NTS