

- WALL TO BE FINISHED WOODEN FLOORING MATERIAL OVER 12MM THK HDHMR PANELING
- 6' X 2'6" X 4" SIGNAGE BOX IN ACRYLIC AS/ DETAIL AND SCHEDULE FIXED ON THE WALL
- 25 X 25MM SS ANGULAR PROFILE FOR CORNER EDGES
- COUNTER TOP TO BE FINISHED IN 12MM THK CORIAN AS/SCHEDULE
- 1200MMX 600MM TILING ON COUNTER FASCIA AS/ SCHEDULE
- 150MM HIGH GRANITE SKIRTING AS/ SCHEDULE

ELEVATION -'CC'

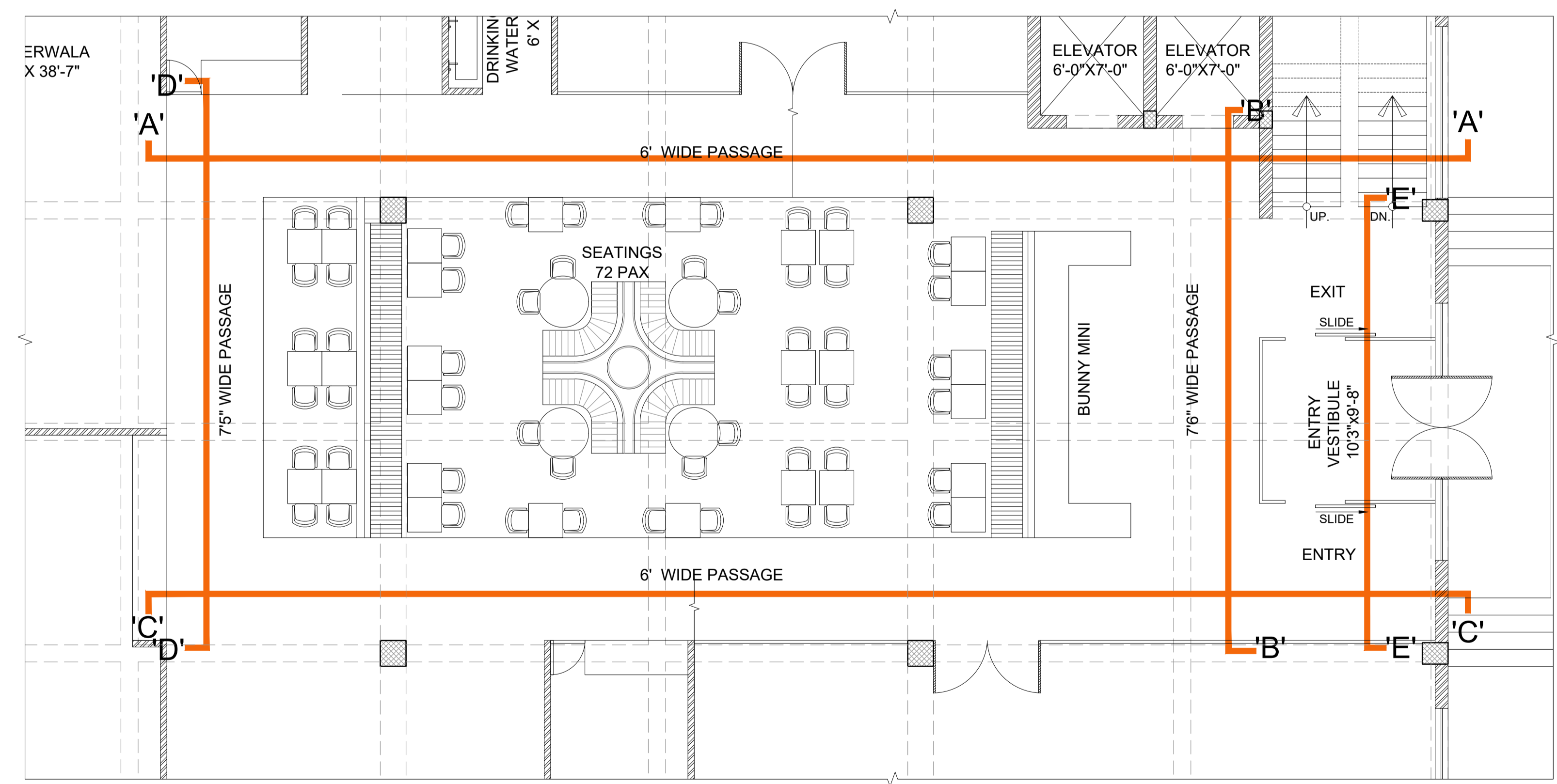

KEY PLAN (COMMON AREA)

PROJECT  
**FOOD COURT**

BLOCK  
**UNA-HIGHWAY**

- General Notes :
1. All dimensions are in millimeters.
  2. Dimensions are to be read and not to be scaled.
  3. The contractors must verify all dimensions on site and refer the relevant STRUCTURAL and other MEP drawings before commencing any work or preparing shop drawings, and in case any discrepancy is noticed the same shall be brought to the notice of the architect and shall be clarified before execution of work.
  4. Refer this drawing along with the other relevant architectural, structural and MEP services drawings.
  5. All Sill & Lintel levels to be considered from FFL.

Rev.	Date	Description	Approved
Revision Index			

CLIENT  
**TFS (R&R) PVT. LTD.**

ARCHITECTS

**PLUGD**  
Ar. Ritika Malik & Ar. Sourabh Khurana  
1st Floor, C-78, Sector-88, Noida - 201305

DRAWING TITLE  
**ELEVATIONS-CC**

<input type="checkbox"/> FOR TENDER	DATE 04-01-2024	PROJ ARCHITECT :
<input type="checkbox"/> FOR INFORMATION	SCALE	DRAWN SAMAYDIN
<input type="checkbox"/> FOR EXECUTION	NTS	CHECKED MANIS
<input type="checkbox"/> FOR APPROVAL		

DRAWING NO <b>PL/UNA/WD/GF/ELE-04</b>	REVISION <b>R0</b>
--	-----------------------

PLUGD  
C-78, Sector 88, Noida-201305

The contents of this drawing constitute the original and unpublished work of PLUGD and no part of the drawing shall be disclosed / modified / used in any manner without their prior consent.